



Vale Grove, Loxley, S6 6TB

Offers Over £450,000

🛏️ 4 🚿 1 🚗 2



Why We Love It

Situated in the picturesque Loxley area of Sheffield, Vale Grove offers the perfect balance of countryside serenity and city convenience. Surrounded by rolling hills and lush greenery, this location is ideal for those who enjoy outdoor activities, with scenic walks and cycling routes right on your doorstep. Despite its tranquil setting, the home is just a short drive from local shops, schools, and excellent transport links into Sheffield city centre.

Why You'll Love It

Nestled in the heart of Loxley, Vale Grove is a stunning home that seamlessly blends contemporary design with timeless character. This spacious property is perfect for those seeking modern living with breathtaking views of the Sheffield countryside.

The first floor welcomes you with a bright hallway leading to four generously sized bedrooms. The rear bedrooms boast spectacular countryside views, creating a serene retreat. A sleek and modern four-piece bathroom suite completes this level, offering a luxurious touch.

Descending the glass banister staircase to the ground floor you'll be captivated by the impressive open-plan lounge and dining area. This space extends into a substantial conservatory, providing an abundance of natural light and access to the beautifully tiered rear garden. Expertly landscaped, this outdoor haven offers ample room for entertaining friends and family in style. There are two convenient storage areas under the conservatory and the kitchen, giving ample space for safe storage.

Back inside, the kitchen is a true highlight – modern, sleek, and designed for both function and style. It features plentiful storage, a breakfast bar for casual dining, and a handy separate utility room to keep things organized.



we are  morfillsmith



we are  morfillsmith

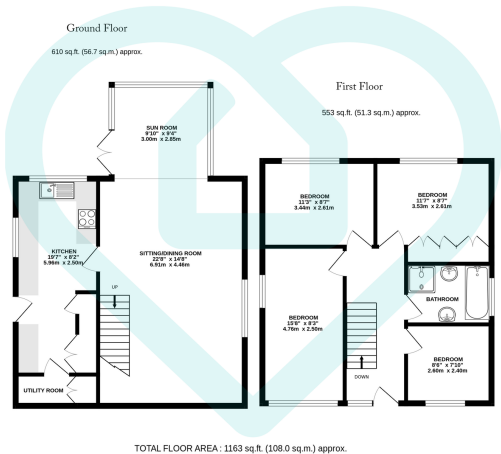

This floor plan is for illustrative purposes only. All measurements and layouts are approximations and do not necessarily capture the precise specifications of the property. No responsibility is taken for any error, omission, or misstatement. We always recommend viewing in person to confirm the exact floor plan of a property. Made with Metropix.



- 4 Bedrooms
- Countryside Views
- Glass Banister Staircase
- Beautifully Tiered Rear Garden
- Local Schools
- Detached Home
- Modern Four-Piece Bathroom
- Impressive Open-Plan Lounge/Diner
- Convenient Loxley Location
- Plenty of Amenities

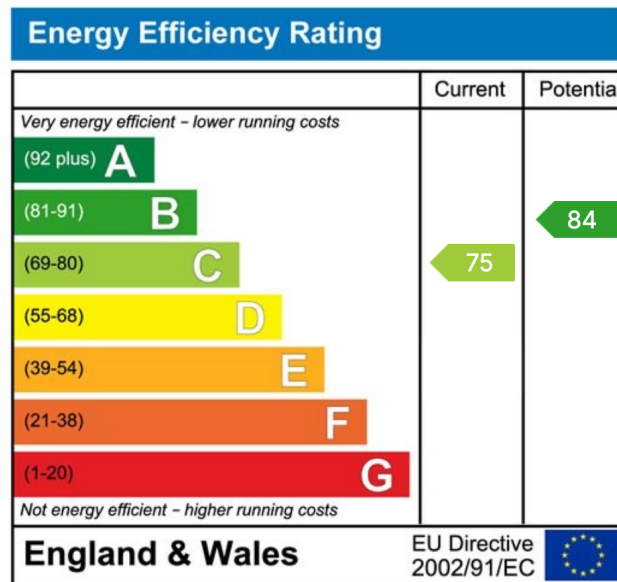

Sales | Lettings | New Homes

VAT Reg Number: 191 3588 84
 Company Reg Number: 08610489
 Company Reg Address: 67 Middlewood Road, Hillsborough, Sheffield, S6 4GX.

The MorfittSmith Building
 67 Middlewood Road
 Hillsborough
 Sheffield
 S6 4GX

Get in touch - arrange an appointment

- 0114 232 1764
- sales@morfittsmith.co.uk
- lettings@morfittsmith.co.uk
- newhomes@morfittsmith.co.uk
- www.morfittsmith.co.uk

- @MorfittSmith
- @MorfittSmith
- MorfittSmith Estate & Letting Agent